

ROSWELL.L.

www.roswellmarine.com

Nautique Triton Clamping Board Rack V2

Installation & Usage Instructions

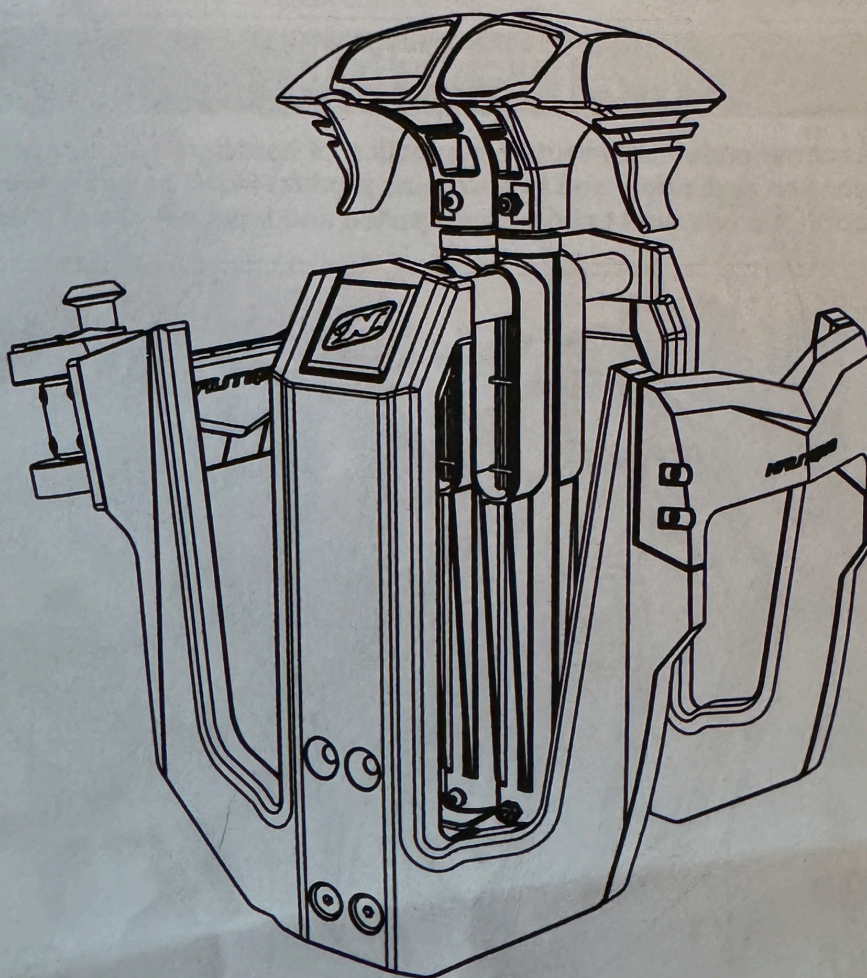

Part # C917-180045

Information: info@roswellglobal.com

If you have any questions please call : 1-321-638-1331



PACKAGE CONTENTS

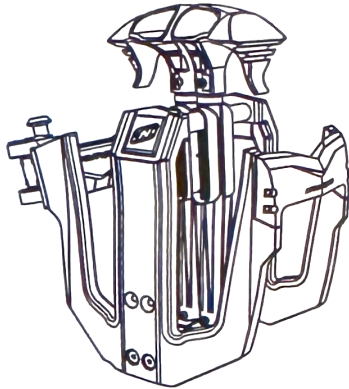

(x2) Nautique Triton V2 Clamping Board Racks with Swivels



x8

TOOLS NEEDED

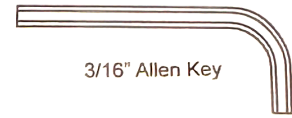

3/16" Allen Key



Torque wrench
with 3/16"
Allen bit



LOCTITE
THREADLOCKER
RED

! ATTENTION !

Roswell strongly recommends that a routine inspection of hardware and components be done to ensure proper function and safety and to maximize product life. If bolts are found to be loose, discontinue use until Loctite is re-applied and bolts are re-tightened.

A

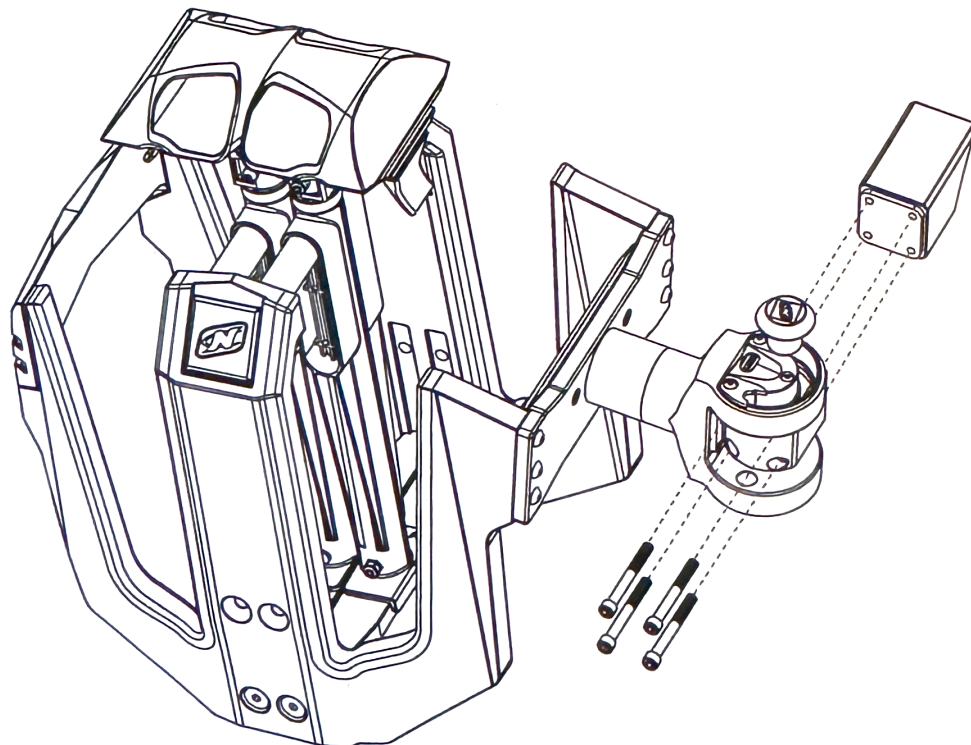

Torque bolts
to 15ft-lb



3/16"



RED

x8

Carefully remove your Nautique Triton V2 racks from the packaging. Mount one to each swivel block on either side of your tower using the hardware provided. The racks are not side specific. Apply red Loctite to all 8 bolts first.

A

Your Triton rack is designed to be adjustable to fit just about any size of wakeboard, wakesurfer or wakeskate. There are 2 settings, one for narrower boards, one for wider boards.

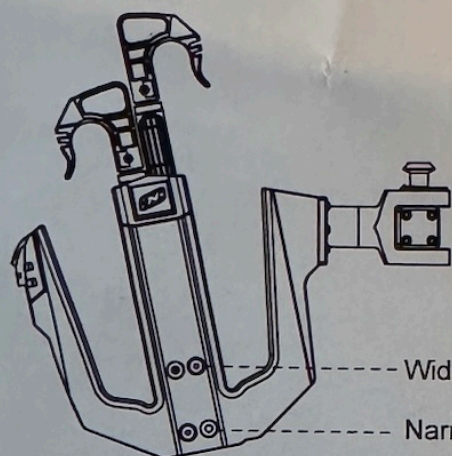

----- Wide board setting

----- Narrow board setting

In the narrow setting, the max board width should be no greater than 20" inches and no less than 14" inches.

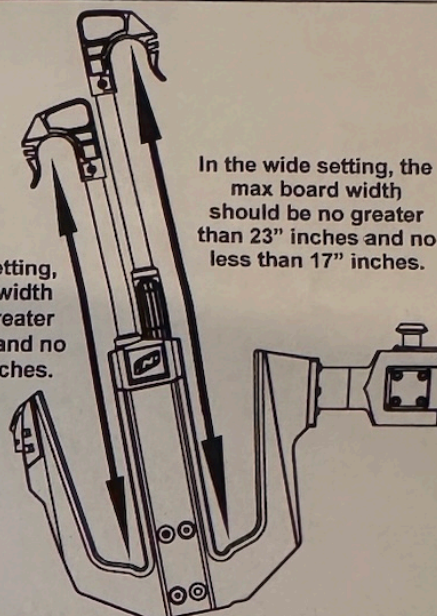

In the wide setting, the max board width should be no greater than 23" inches and no less than 17" inches.

B

Adjust your telescopic arms one at a time. To adjust your telescopic arms loosen and remove the bolt on each side of the rack for the same arm. Do not remove all 4 bolts at the same time. Slide the whole arm assembly up or down to the next position. Re-apply red Loctite to the bolts and tighten.

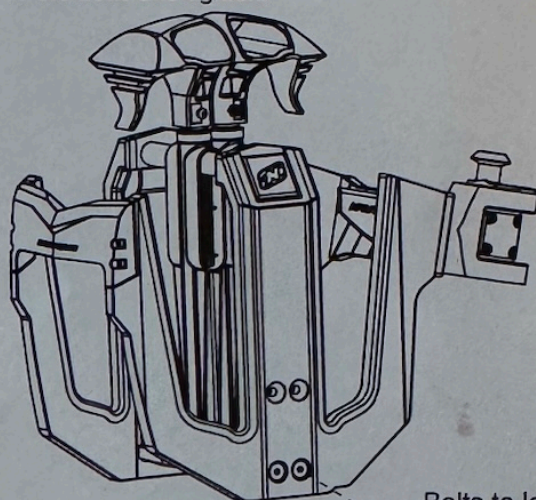

----- Bolts to loosen & remove

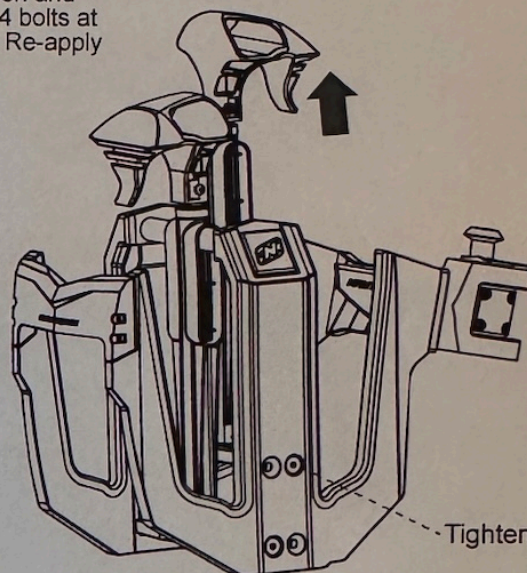

----- Tighten



3/16" RED

C

Inserting Boards



1 : Slide your board into one of the Triton rack slots.

2 : Pull up on the telescopic arm and flip your board towards it.

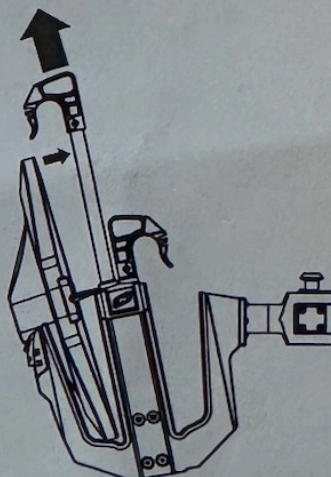

3 : Let the telescopic arm clamp down over your board.
To remove a board, repeat steps 1-3 in reverse

