



Ahead of the Curve®

JL AUDIO®

M A R I N E



Ahead of the Curve®

NAUTIQUE®

JL AUDIO®

M A R I N E



COMMITMENT TO THE MARINE INDUSTRY





M600/6 Control Panel

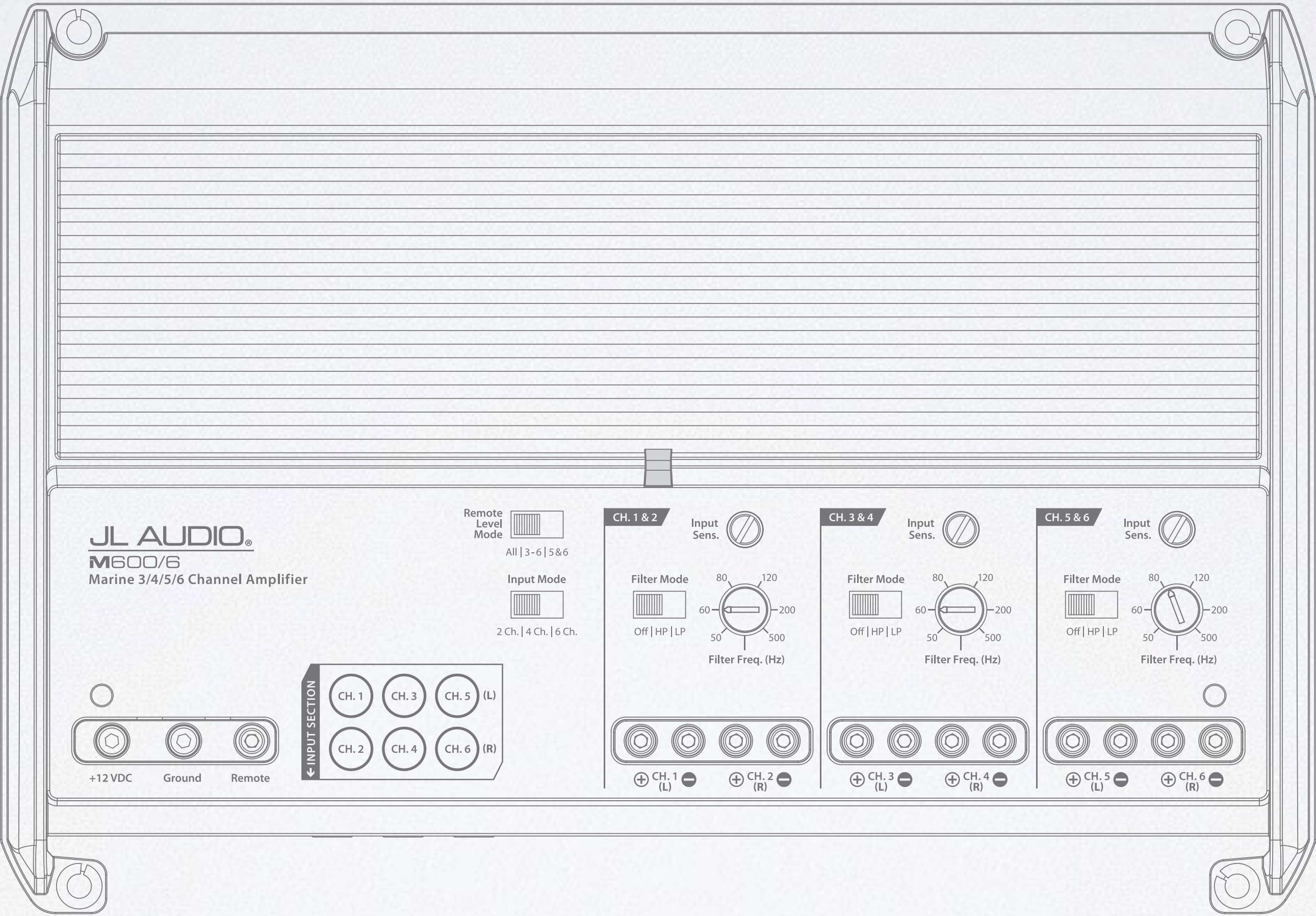



Area of the Curve®

M600/6 Control Panel

JL AUDIO®

M600/6

Marine 3/4/5/6 Channel Amplifier

Remote
Level
Mode



All | 3-6 | 5&6

Input Mode



2 Ch. | 4 Ch. | 6 Ch.

← INPUT SECTION



+12 VDC

Ground

Remote

CH. 1 & 2

Input
Sens.



Filter Mode



Off | HP | LP

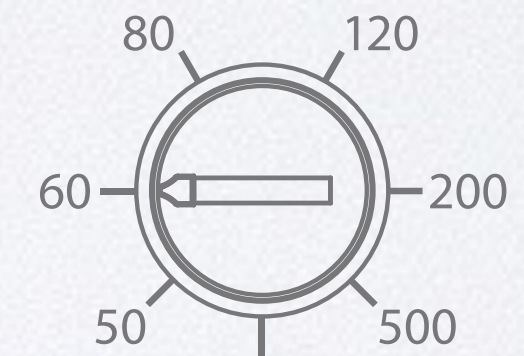

Filter Freq. (Hz)

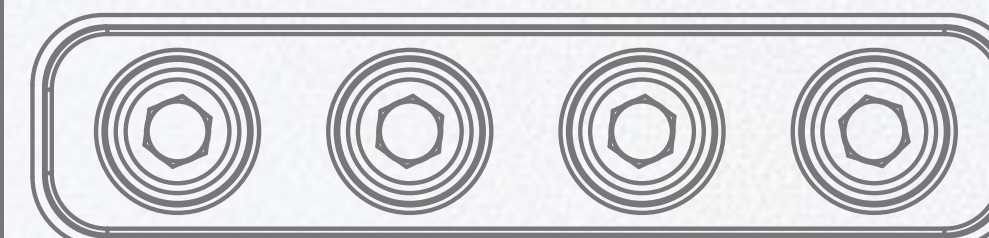

⊕ CH. 1 (L) ⊖

⊕ CH. 2 (R) ⊖

CH. 3 & 4

Input
Sens.



Filter Mode



Off | HP | LP

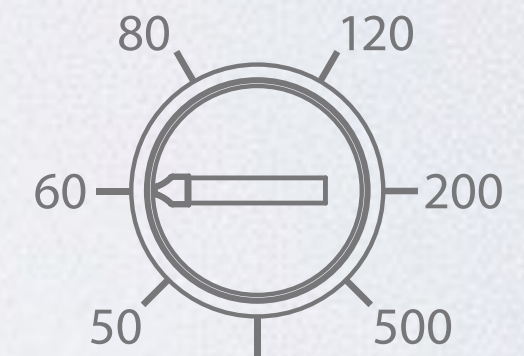

Filter Freq. (Hz)

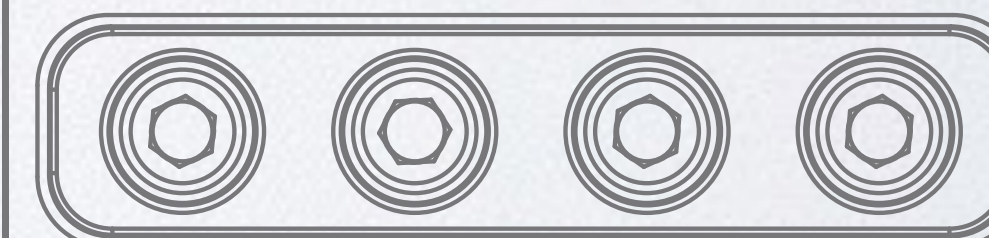

⊕ CH. 3 (L) ⊖

⊕ CH. 4 (R) ⊖



M600/6 Control Detail

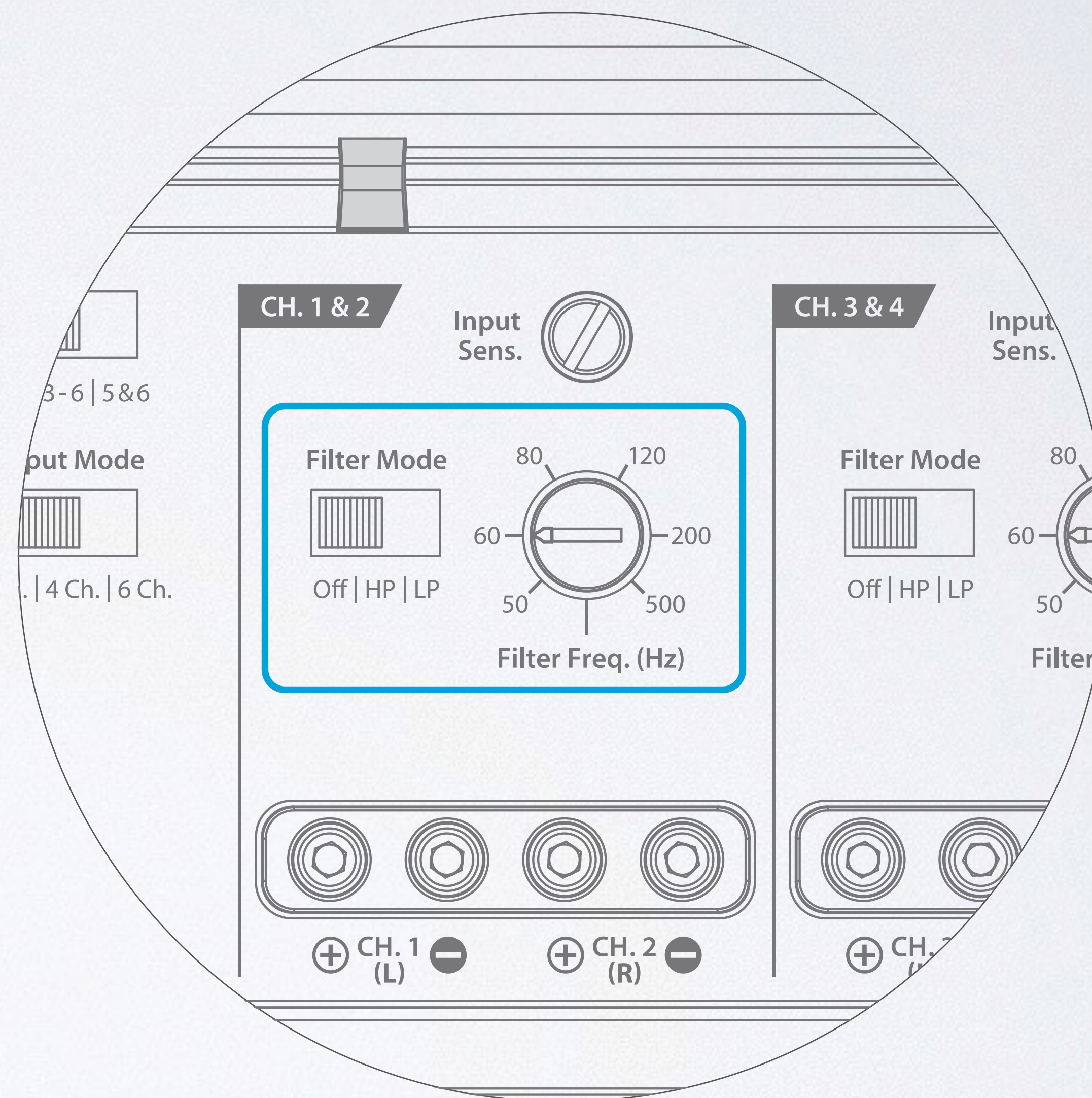



M600/6 Control Detail

- Crossover (Filter) Controls

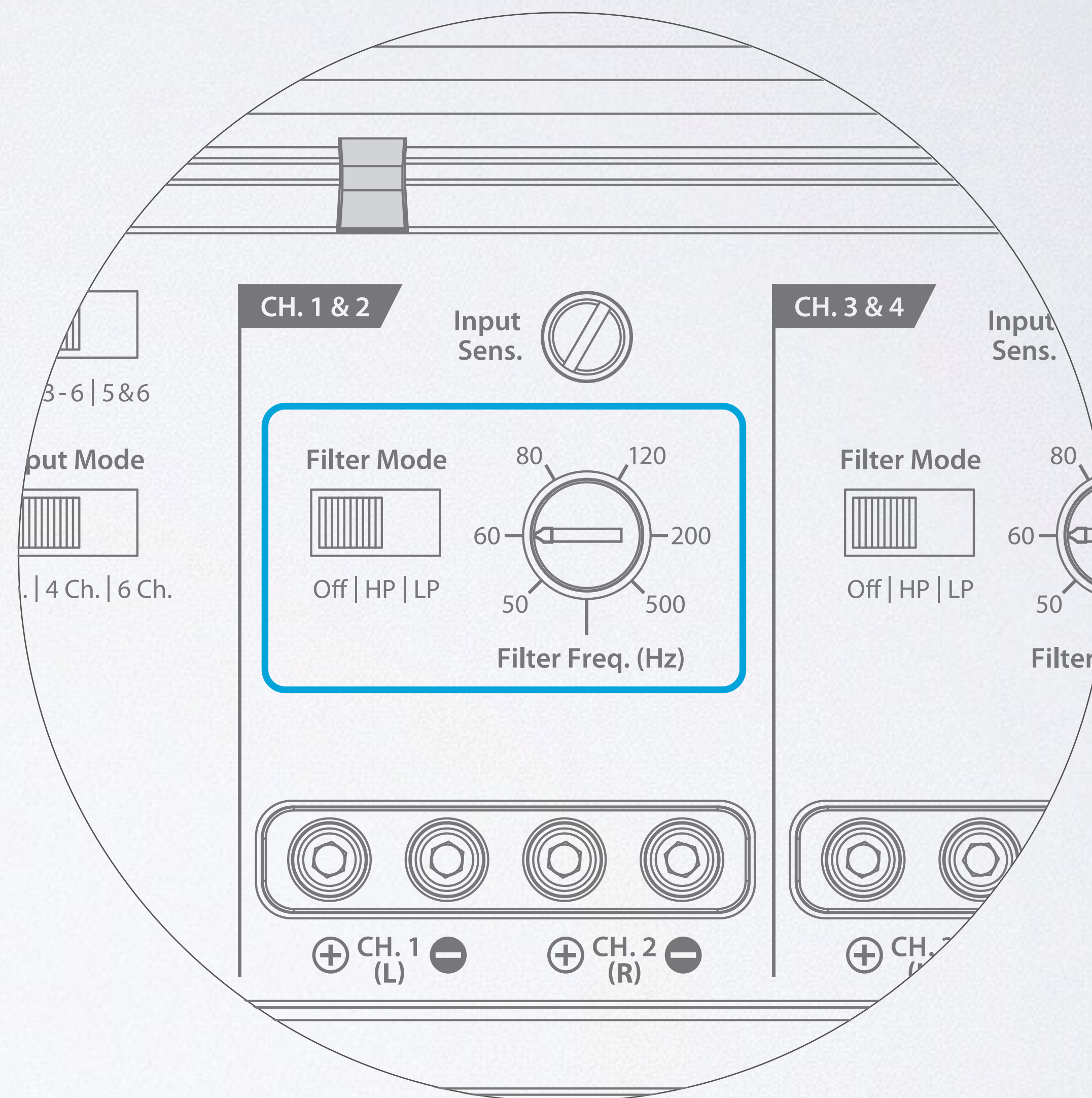



What is an Active Crossover?



M600/6 Control Detail

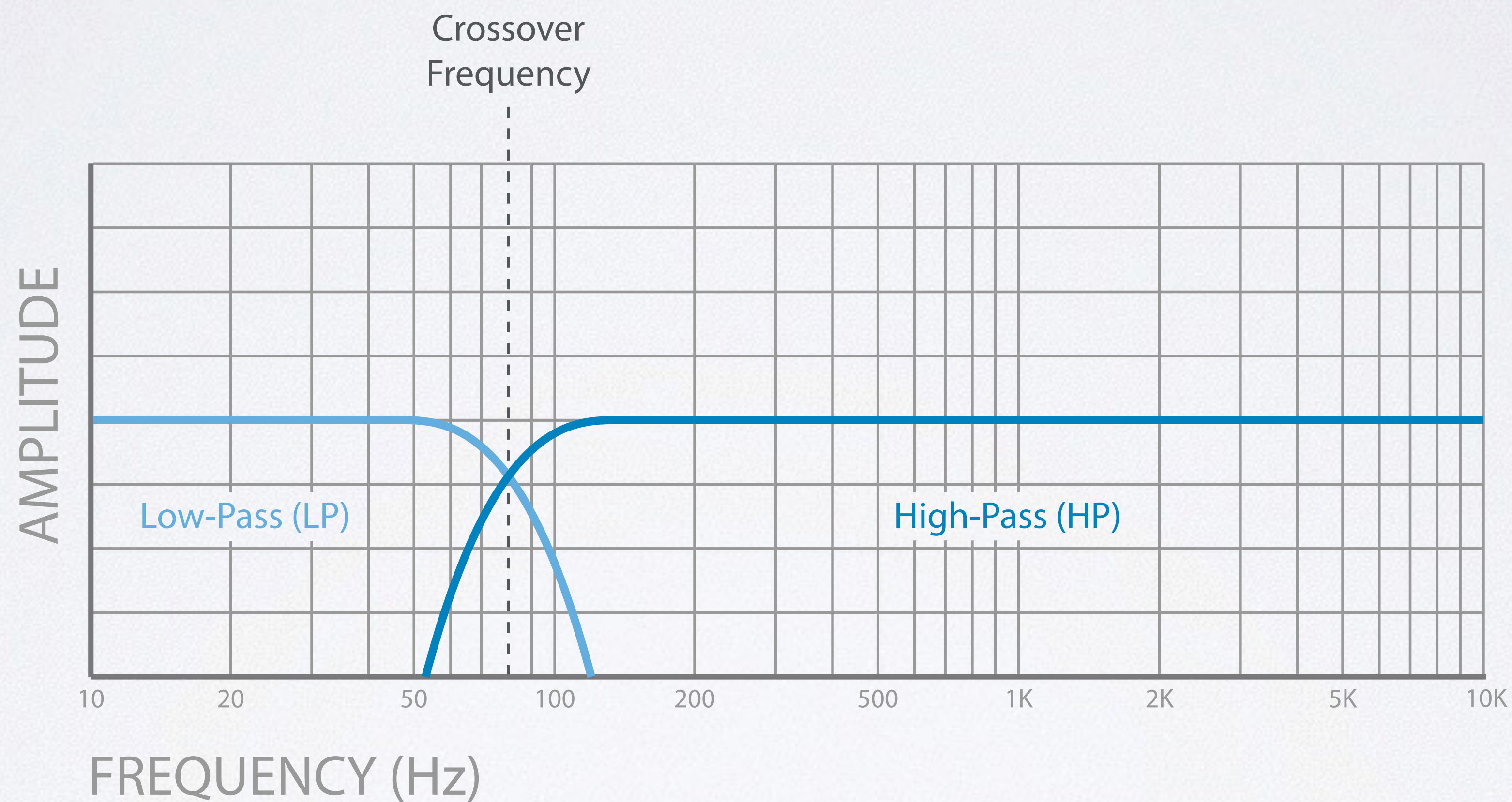



M600/6 Control Detail

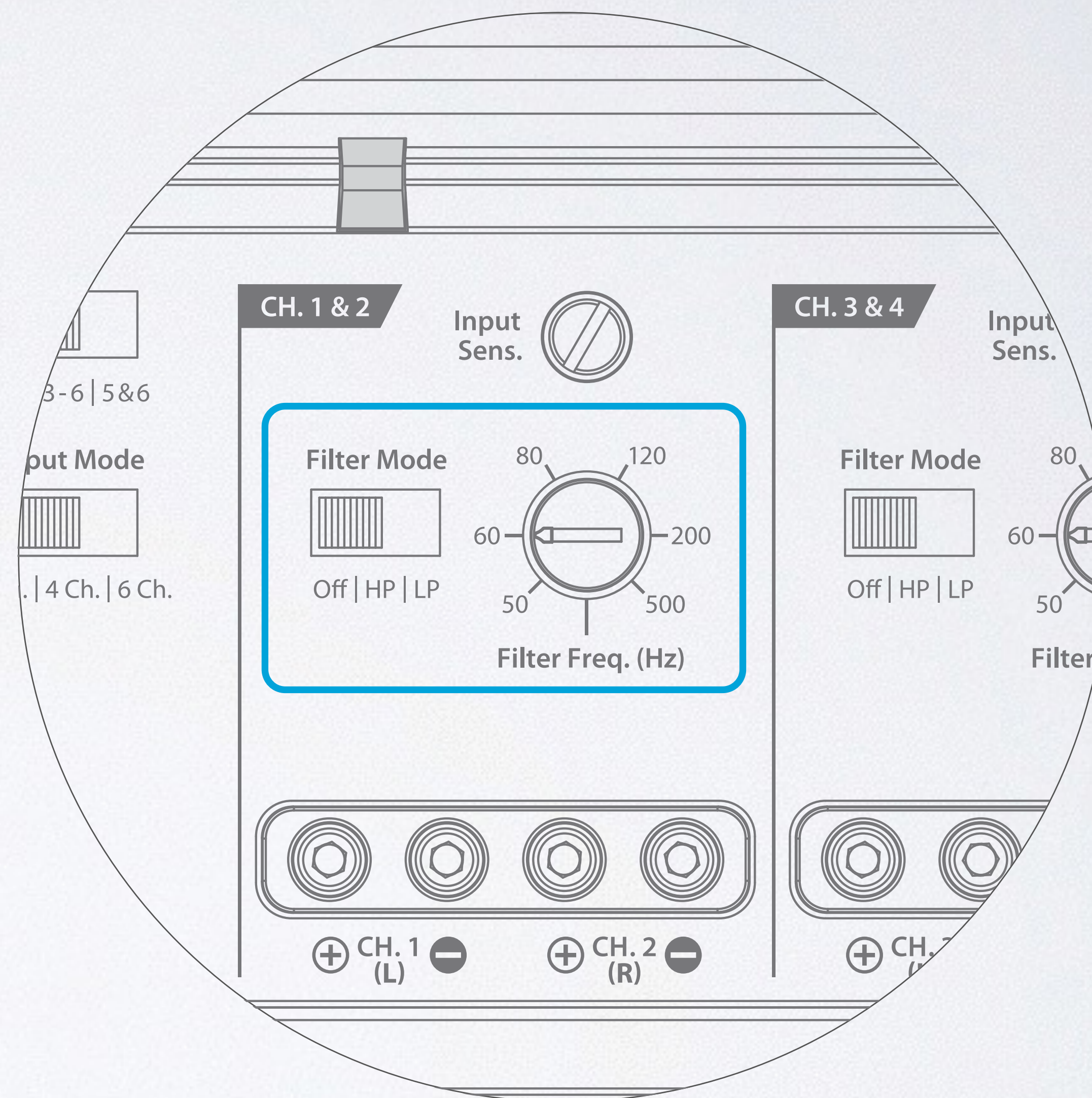



M600/6 Control Detail

- Crossover (Filter) Controls

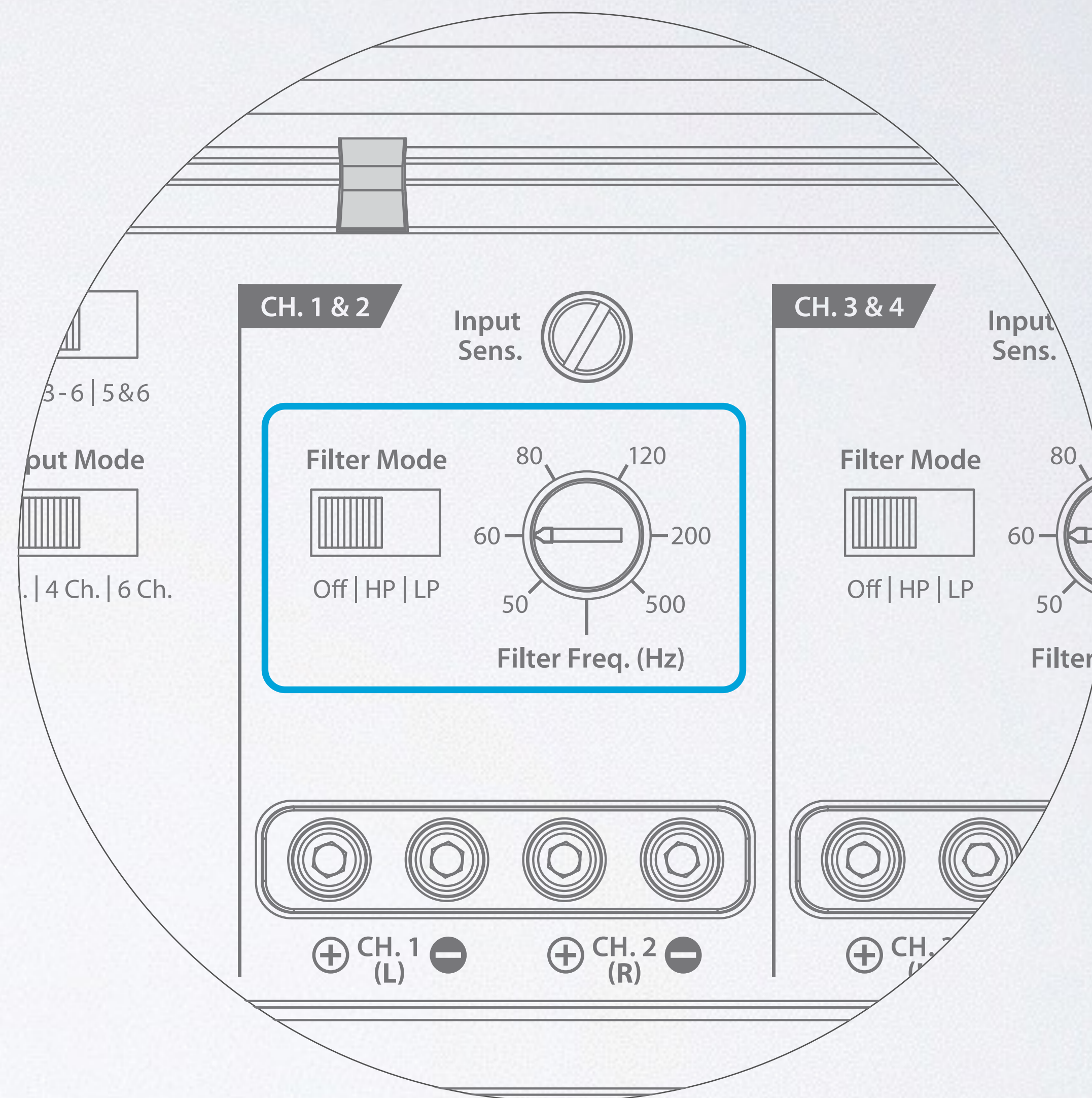



Ahead of the Curve®

Demo



M600/6 Control Panel

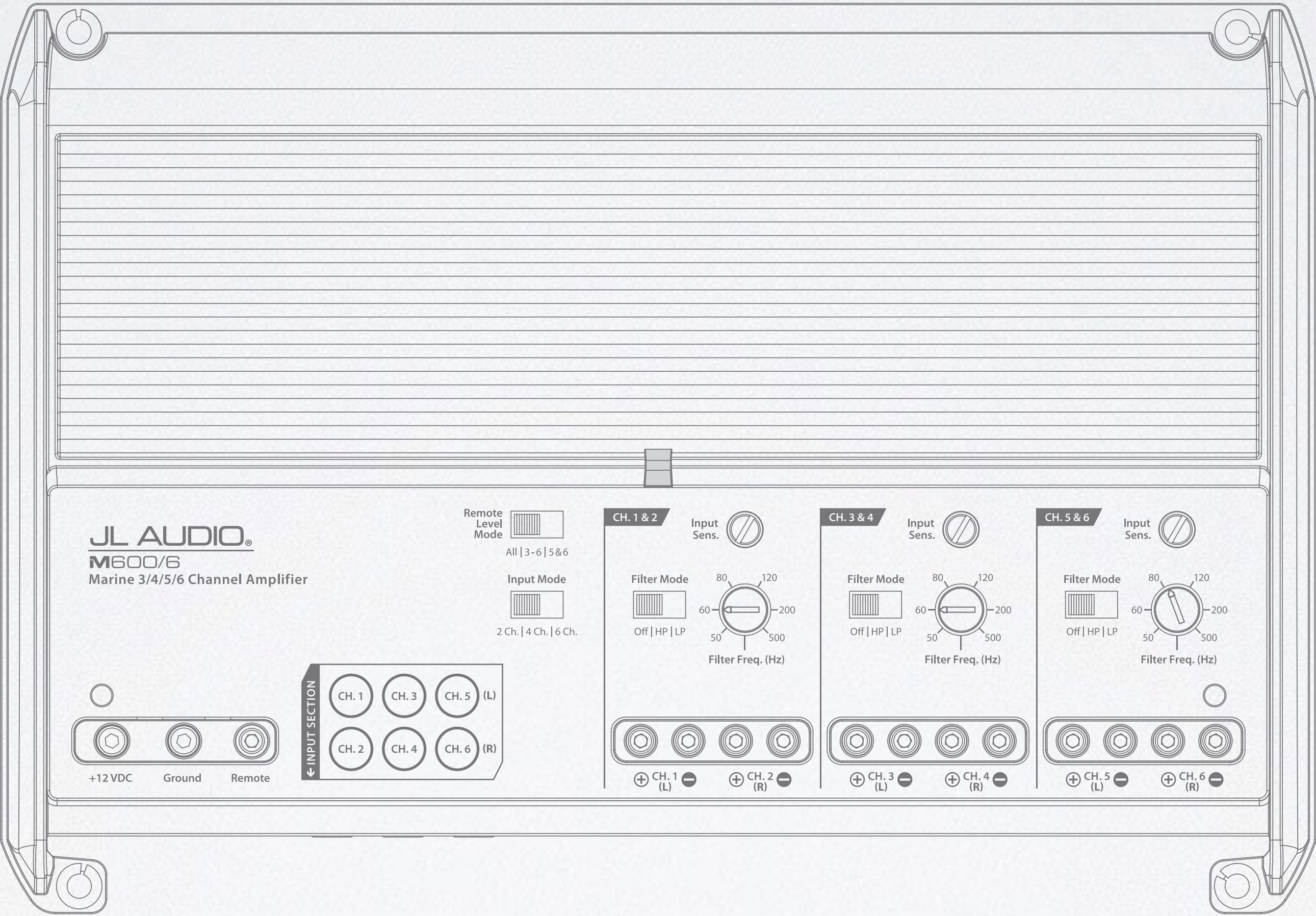



Area of the Curve®

M600/6 Control Panel

JL AUDIO®

M600/6

Marine 3/4/5/6 Channel Amplifier

Remote
Level
Mode



All | 3-6 | 5&6

Input Mode



2 Ch. | 4 Ch. | 6 Ch.

← INPUT SECTION



+12 VDC

Ground

Remote

CH. 1 & 2

Input
Sens.



Filter Mode



Off | HP | LP

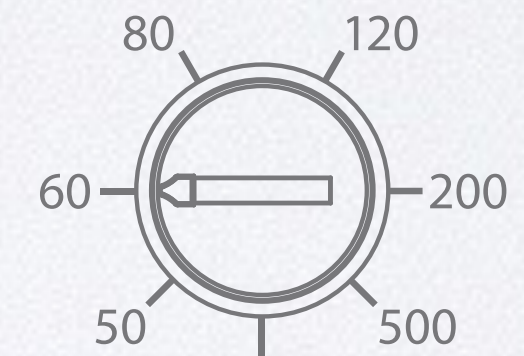

Filter Freq. (Hz)

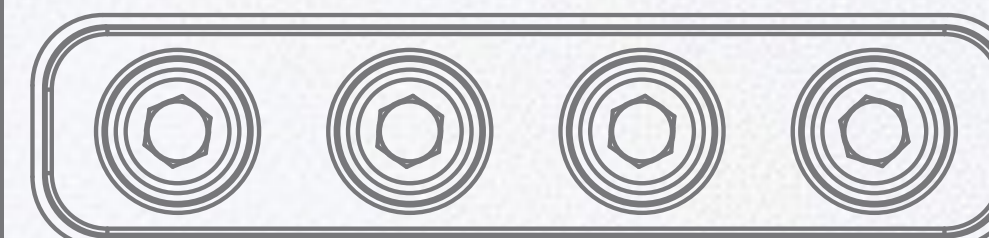

⊕ CH. 1 (L) ⊖

⊕ CH. 2 (R) ⊖

CH. 3 & 4

Input
Sens.

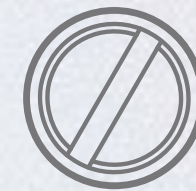

Filter Mode



Off | HP | LP

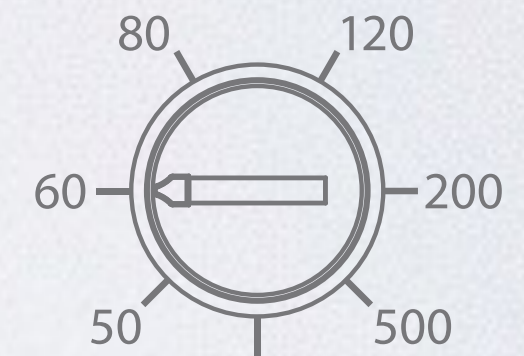

Filter Freq. (Hz)

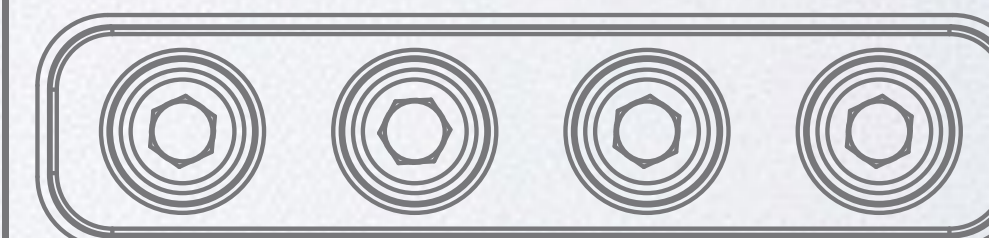

⊕ CH. 3 (L) ⊖

⊕ CH. 4 (R) ⊖



M600/6 Control Detail

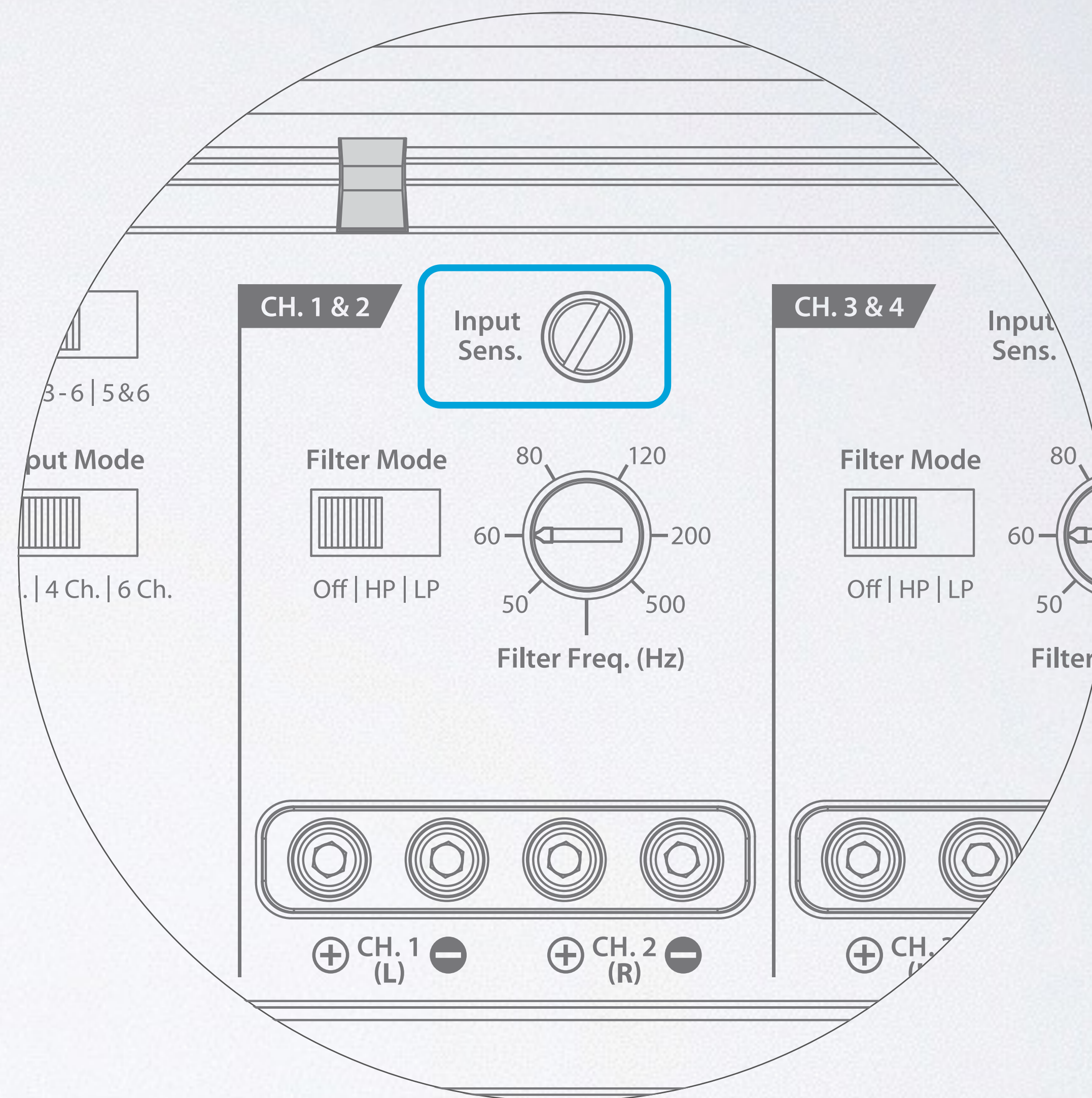



M600/6 Control Detail

- Input Sensitivity (Gain)

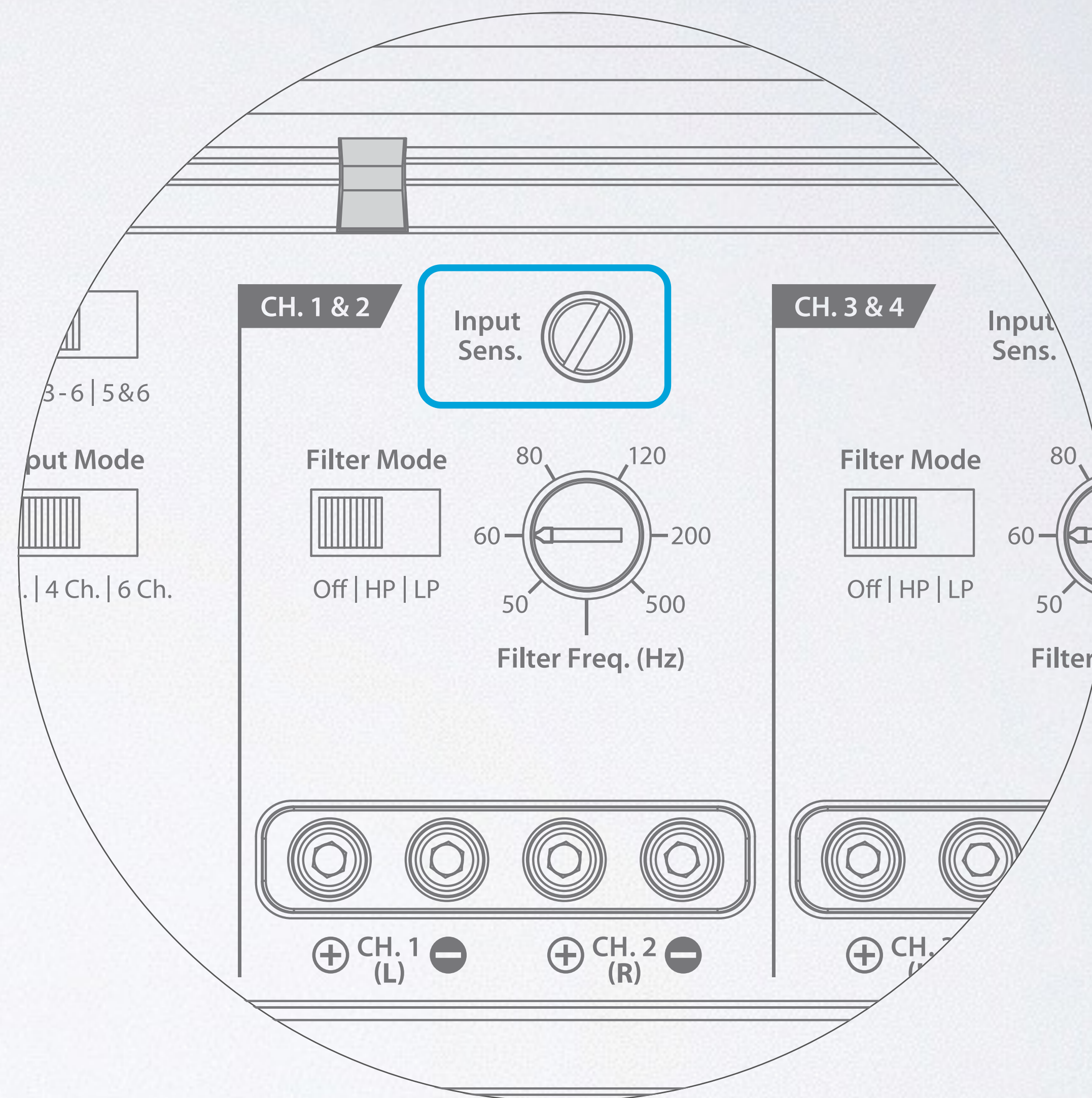



What is a Gain Control?



M600/6 Control Panel

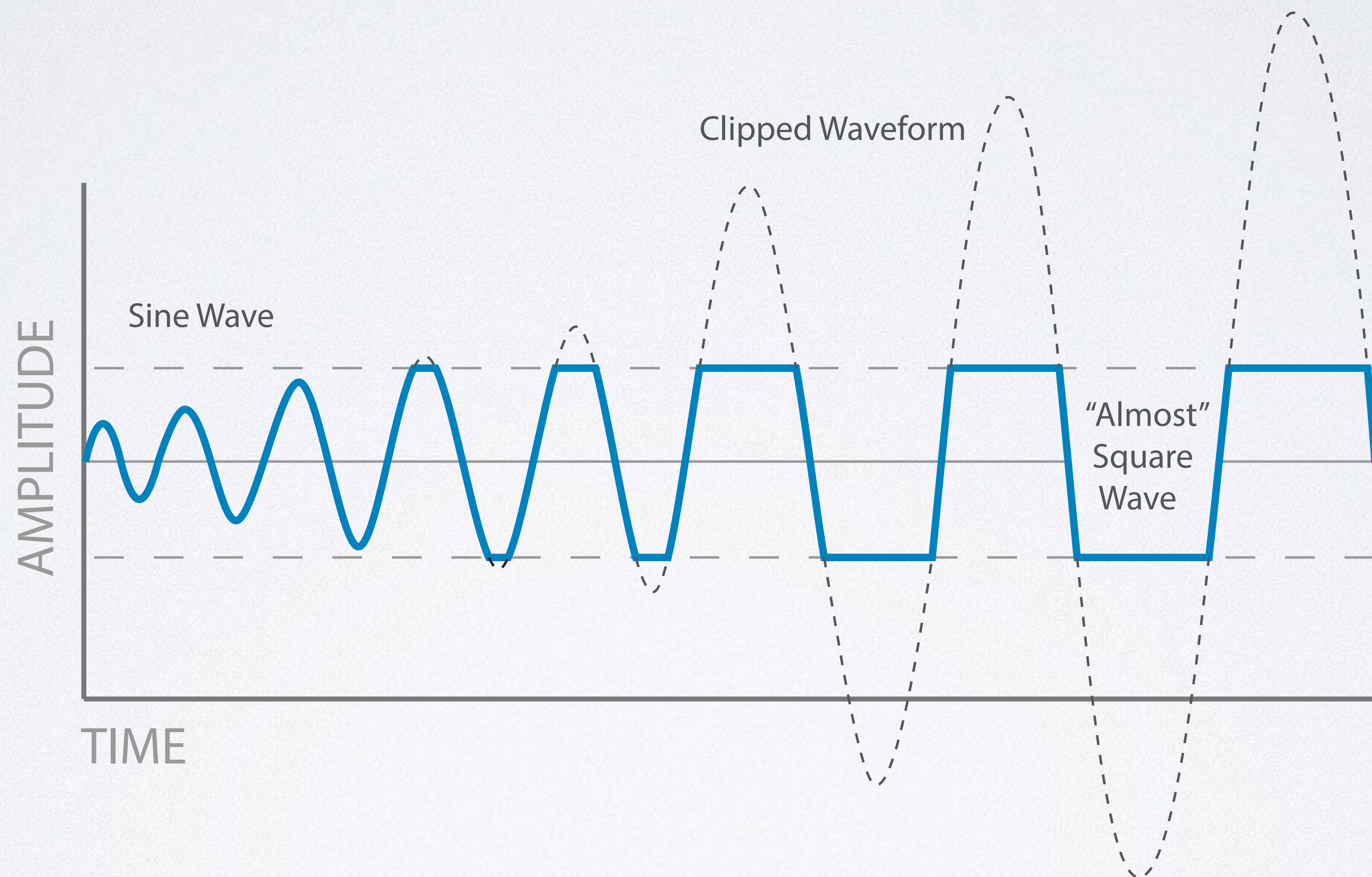



Ahead of the Curve®

Demo



M600/6 Control Panel

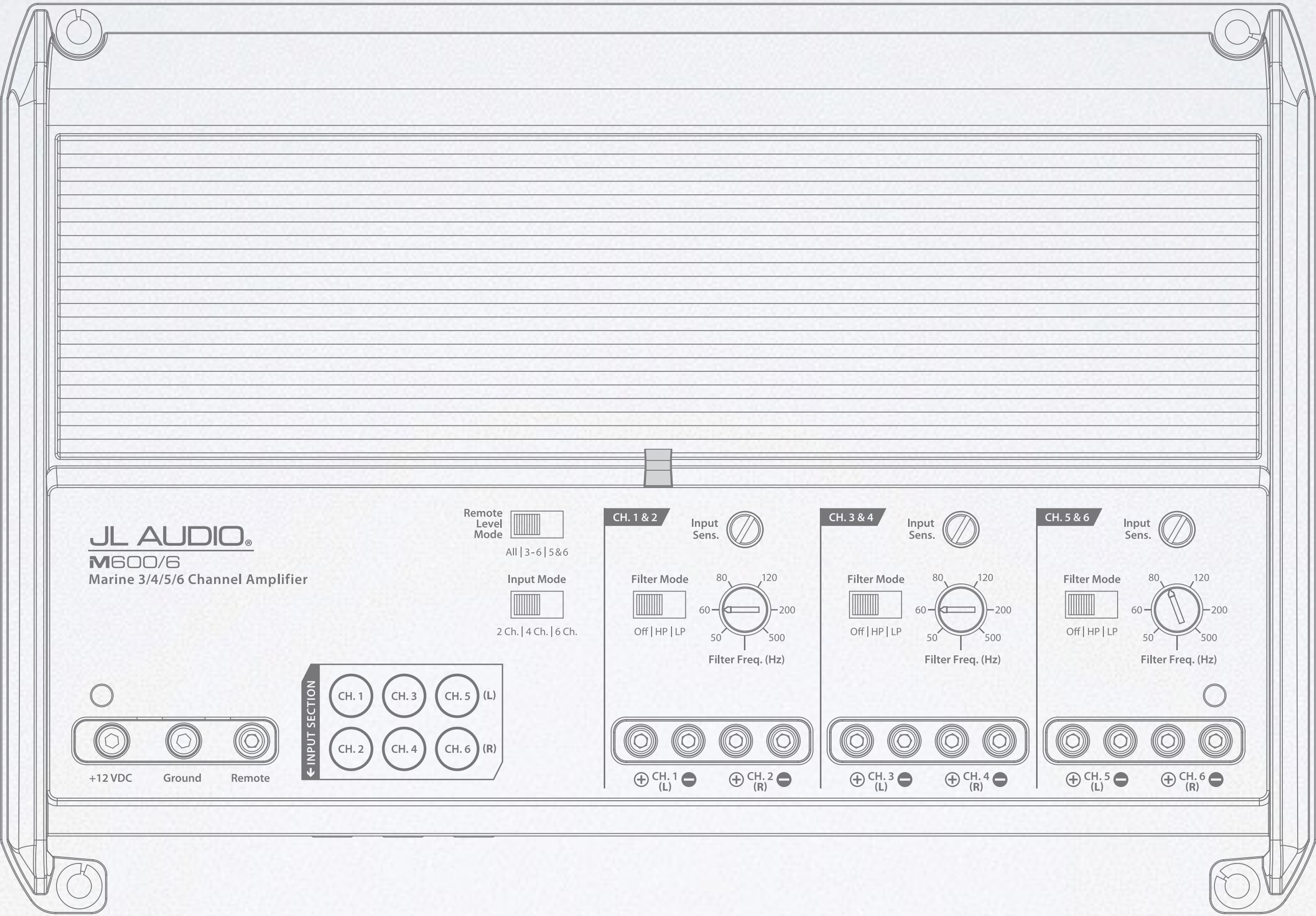



M600/6 Control Panel

JL AUDIO®

M600/6

Marine 3/4/5/6 Channel Amplifier

Remote Level Mode



All | 3-6 | 5&6

Input Mode



2 Ch. | 4 Ch. | 6 Ch.

← INPUT SECTION

CH. 1

CH. 3

CH. 5 (L)

CH. 2

CH. 4

CH. 6 (R)

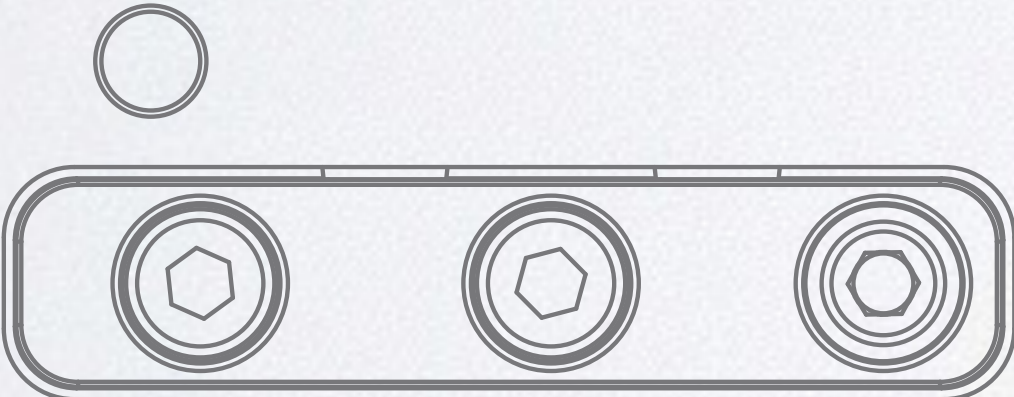

+12 VDC

Ground

Remote

CH. 1 & 2

Input Sens.



Filter Mode



Off | HP | LP

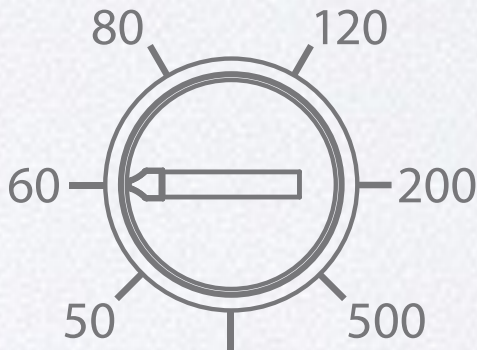

Filter Freq. (Hz)

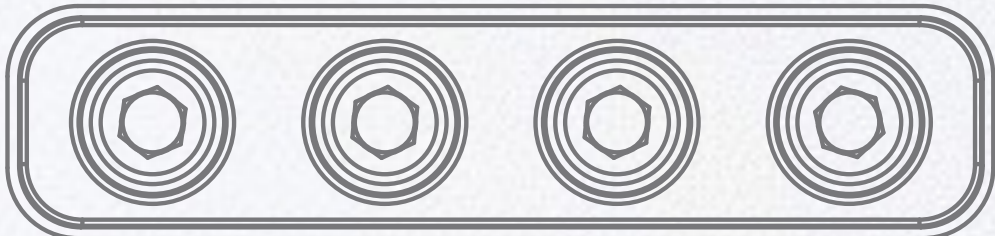

⊕ CH. 1 (L) ⊖

⊕ CH. 2 (R) ⊖

CH. 3 & 4

Input Sens.



Filter Mode



Off | HP | LP

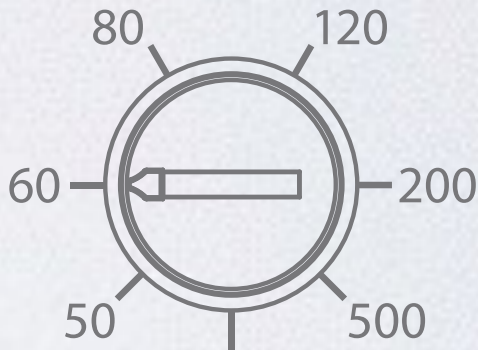

Filter Freq. (Hz)

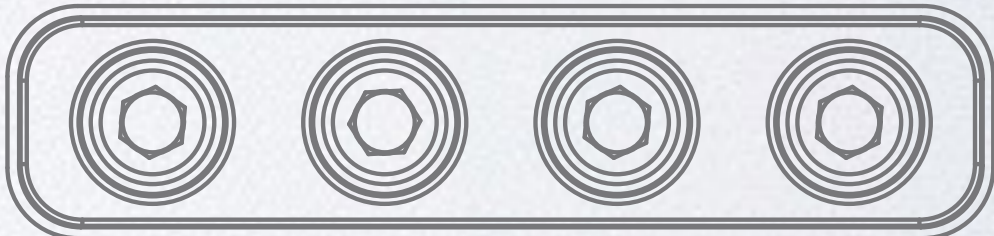

⊕ CH. 3 (L) ⊖

⊕ CH. 4 (R) ⊖



M600/6 Control Detail

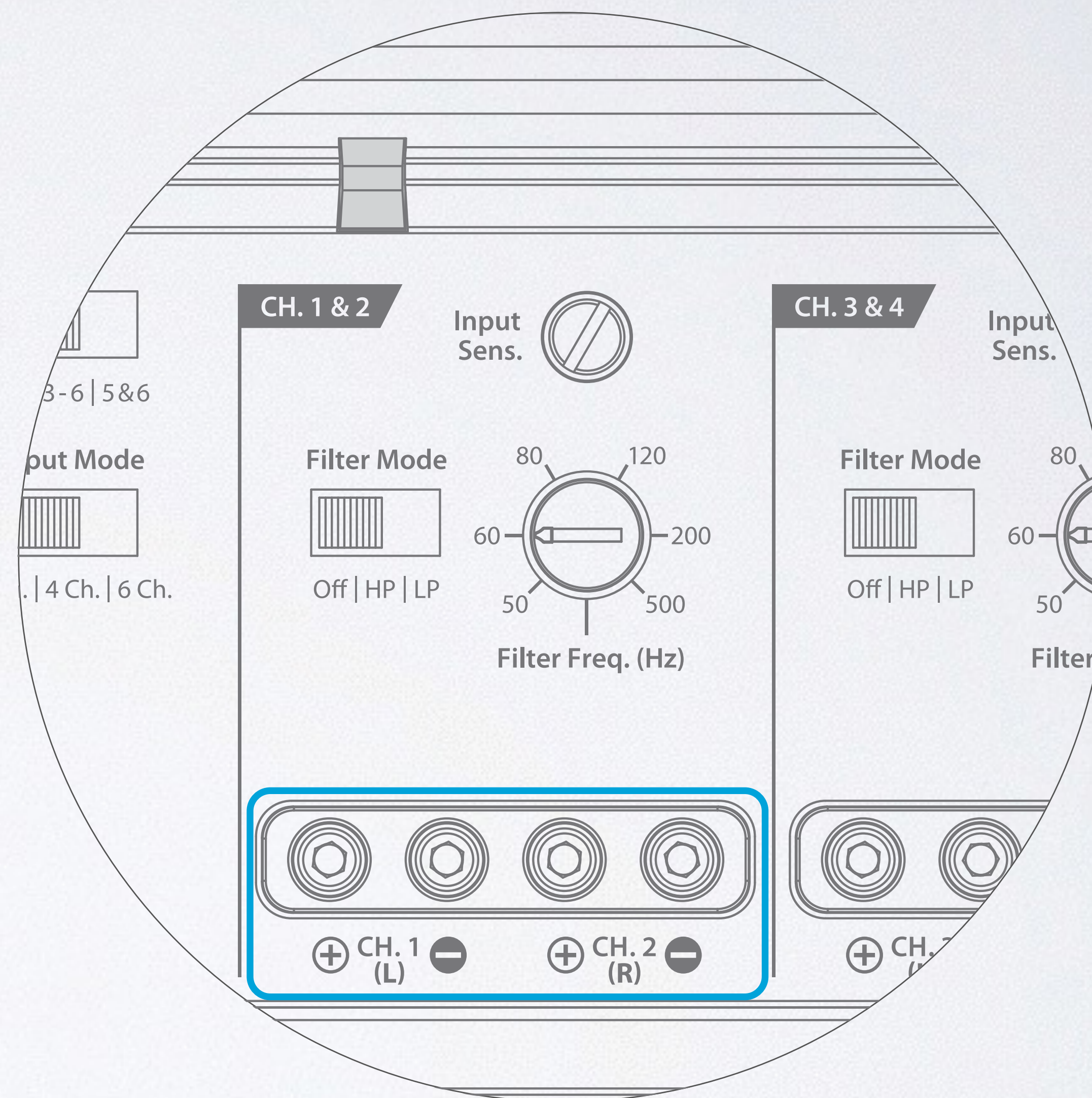



M600/6 Control Detail

- Speaker Connections

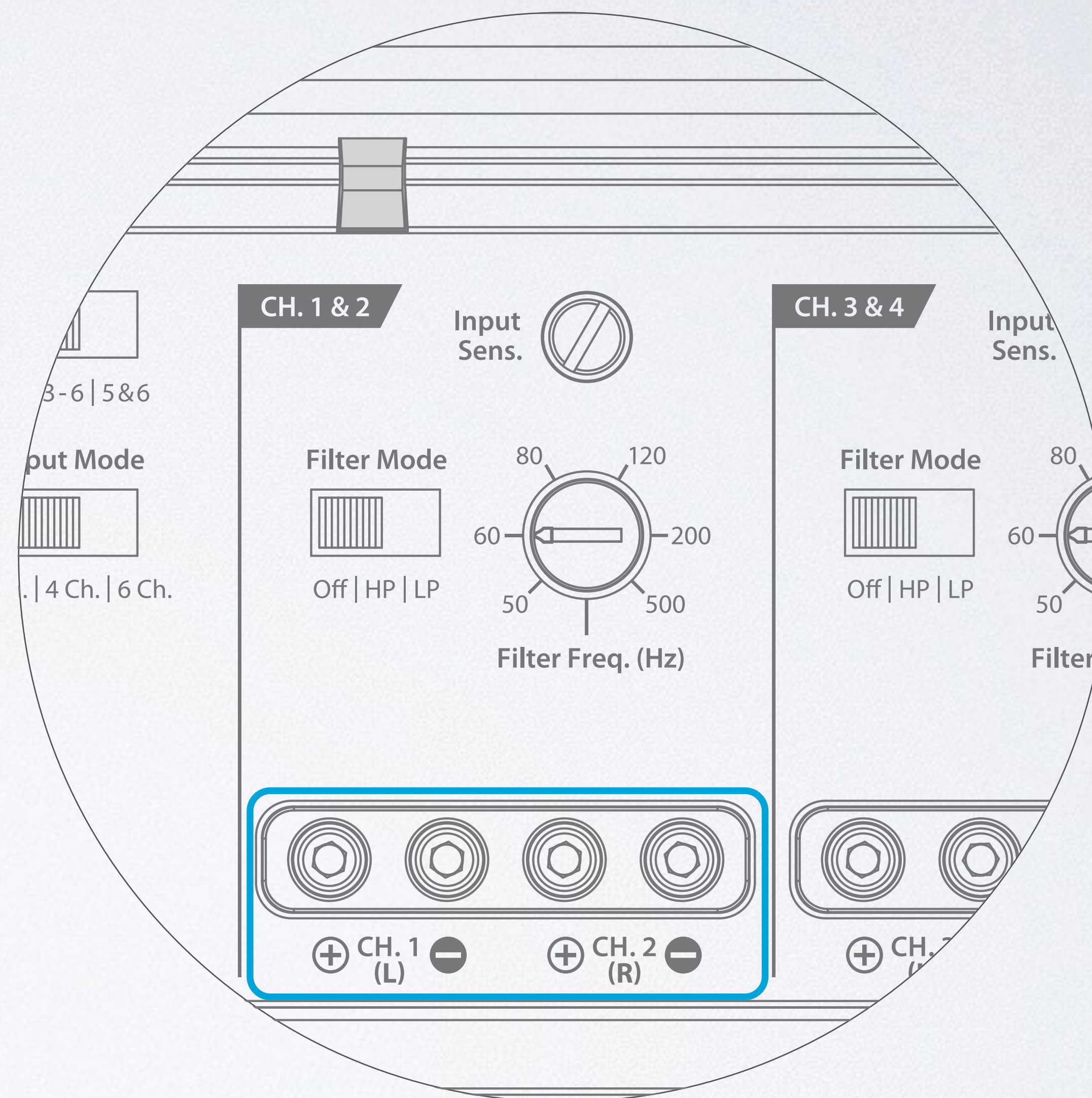

M600/6 Control Detail

- Speaker Connections

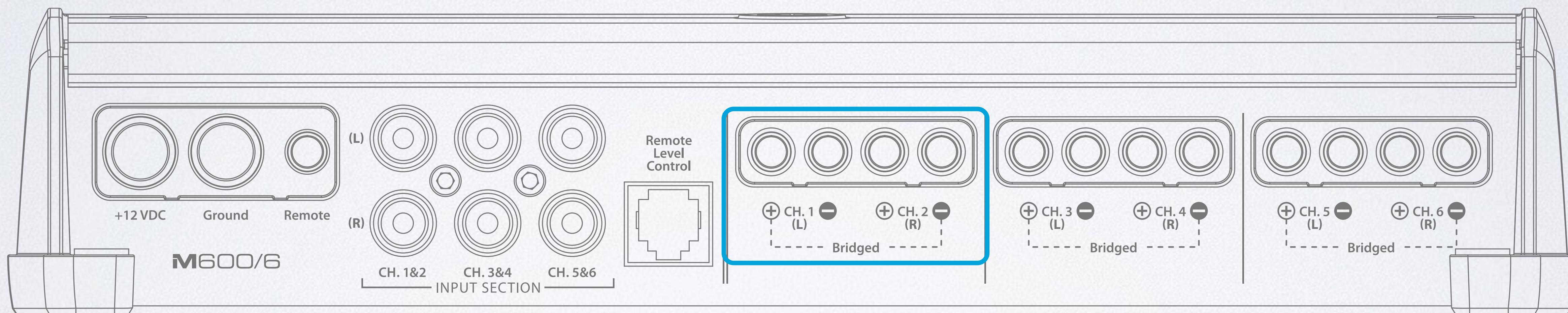



Ahead of the Curve®

Demo



Thank You



Ahead of the Curve®

NAUTIQUE®

JL AUDIO®

M A R I N E